



# Ore-Cutts

Volume XLVIV Number 6

June 2012

**Please join us on June 9, 2012 from 11:00 am till 3:00 pm at Pioneer Park for the annual OMS BBQ & Picnic and semiannual meeting.** The CLUB will be providing the meat and bread. YOU will bring your favorite potluck dish to share, your plates, cutlery, drinks, tablecloth, (and perhaps something to cover the bench-the birds, you know,) the spouse, the kids, the dog (on leash,) and rocks for the silent auction as well as your mad money for the auction. We will also be doing any club business that is in need of attention. This is an excellent facility with lots of shade and a nearby "comfort station." Bring your appetite and your camera for a great, relaxing afternoon with friends!

## The Prez Box

By Debbie Hood

It is time for the Semi-annual meeting & picnic. This is always a fun event with great food, a great silent auction, and good fellowship. Last year it was a bit cool and damp, but this year looks to be sunny, warm and dry.

We have posters and flyers ready for you to pick up and take everywhere you go; the doctor's office, the beauty/barber shop, the grocery store, and so on. Give them to all your friends, relatives and neighbors. Put them on every bulletin board you see. Please, always politely ask permission to place our flyers first. We need to be assertive about getting the word out this year due to the venue change to Nipomo High School as well as current economic conditions. The show is a great free, family activity and the more folks we draw to it the more successful the show will be!

We will also have Treasure Chest Tickets for you to take and sell. Remember this is one of the money-makers of our show which allows us to fund the scholarships to local students in the Earth Sciences. So please try to sell as many tickets as you can!

June 11 a group of us will be going to the High School will be talking with the administration and finalizing just what areas we will be using, and maybe even getting a better idea of how much the venue will cost us. If you have questions or input, contact me, Wes Lingerfelt or Marge Henson.

See you all at the June Pic-nic!



## Sunshine

Sandy Berthelot has been hospitalized in Santa Barbara with possible pneumonia and some

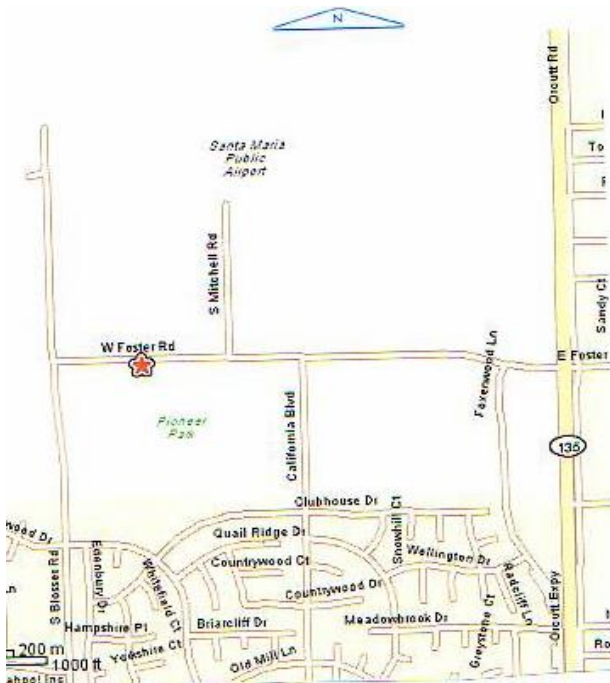

complications from it. It is unclear exactly what is wrong, but we hope that her Doctors are able to sort it out and get her back on her feet!

As always, please call and let Debby Hood know if anyone is ill.

### Rock Breakfast

We had 12 members present for the Breakfast at The Sunset Grill Restaurant this month. We began passing out tickets for the Treasure Chest for our show for members to sell, as well as posters and fliers for folks to distribute. There was lots of good food and great fellowship.

### Birthdays & Anniversaries

Birthday greetings go out to those who are having birthdays in June: Ralph Bishop, Gloria Dana, Mike Schmidt, Geary Scheffer, & Maida Williams. *Happy Birthday to all of you & Many more!*

Members celebrating an anniversary are: Don & Gloria Dana, Jan & Stan Ferguson, Bill & Debbie Hood, and Roger & Donna Lehman. *Many Happy Returns of this day!*



### May Program – California Blue Mine

Wes Lingerfelt showed a great slide presentation of his recent trip to the California Blue Mine. There are many great specimens and gem aquamarines, smoky quartz, Clevelandite, mica and others, being brought to light there. Wes believes this mine will rival any of the other famous American gem mines someday.



The following is excerpted from Wikipedia to give you some info on Aquamarines. Aquamarine and maxixe Aquamarine (from Latin: aqua marina, "water of the sea") is a blue or turquoise variety of beryl. It occurs at most localities which yield ordinary beryl. The gem-gravel placer deposits of Sri Lanka contain aquamarine. Clear yellow beryl, such as that occurring in Brazil, is sometimes called aquamarine chrysolite. The deep blue version of aquamarine is called maxixe. Maxixe is commonly found in the country of Madagascar. Its color fades to white when exposed to sunlight or is subjected to heat treatment, though the color returns with irradiation.

The pale blue color of aquamarine is attributed to Fe<sup>2+</sup>. The Fe<sup>3+</sup> ions produce golden-yellow color, and when both Fe<sup>2+</sup> and Fe<sup>3+</sup> are present, the color is a darker blue as in maxixe. Discoloration of maxixe by light or heat thus

may be due to the charge transfer Fe<sup>3+</sup> and Fe<sup>2+</sup>. Dark-blue maxixe color can be produced in green, pink or yellow beryl by irradiating it with high-energy particles (gamma rays, neutrons or even X-rays).

In the United States, aquamarines can be found at the summit of Mt. Antero in the Sawatch Range in central Colorado. In Wyoming, aquamarine has been discovered in the Big Horn Mountains, near Powder River Pass. (Obviously this was written prior to the California Blue find-Ed.) In Brazil, there are mines in the states of Minas Gerais, Espírito Santo, and Bahia, and minorly in Rio Grande do Norte. The Mines of Colombia, Zambia, Madagascar, Malawi, Tanzania and Kenya also produce aquamarine.

The largest aquamarine of gemstone quality ever mined was found in Marambaia, Minas Gerais, Brazil, in 1910. It weighed over 110 kg, and its dimensions were 48.5 cm (19 in) long and 42 cm (17 in) in diameter.

### Pegmatites

From Wikipedia, the free encyclopedia  
*(Okay, I know this article has lots of big words in it, so you can either get out your dictionaries and learn a new word or two, or you can do as I do and just skip the words I don't know and hope I still get something out of it. Just thought you'd like to know a bit about how the Aqua forms.-Ed.)*

A pegmatite is a very crystalline, intrusive igneous rock composed of interlocking crystals usually larger than 2.5 cm in size; such rocks are referred to as pegmatitic.

Most pegmatites are composed of quartz, feldspar and mica; in essence granite. Rarer intermediate composition and mafic pegmatites containing amphibole, Ca-plagioclase feldspar, pyroxene and other minerals are known, found in recrystallized zones and apophyses associated with large layered intrusions.

Crystal size is the most striking feature of pegmatites, with crystals usually over 5 cm in size. Individual crystals over 10 meters across have been found, and the world's largest crystal was found within a pegmatite.

Similarly, crystal texture and form within pegmatitic rock may be taken to extreme size and perfection. Feldspar within a pegmatite may display exaggerated and perfect twinning, exsolution lamellae, and when affected by hydrous crystallization, macro scale graphic texture is known, with feldspar and quartz intergrown. Perthite feldspar within a pegmatite often shows gigantic perthitic texture visible to the naked eye.

#### Petrology

Crystal growth rates in pegmatite must be incredibly fast to allow gigantic crystals to grow within the confines and pressures of the Earth's crust. For this reason, the

consensus on pegmatitic growth mechanisms involves a combination of the following processes;

- Low rates of nucleation of crystals coupled with high diffusivity to force growth of a few large crystals instead of many smaller crystals,
- High vapor and water pressure, to assist in the enhancement of conditions of diffusivity,
- High concentrations of fluxing elements such as boron and lithium which lower the temperature of solidification within the magma or vapor,
- Low thermal gradients coupled with a high wall rock temperature, explaining the preponderance for pegmatite to occur only within green schist metamorphic terranes.

Despite this consensus on likely chemical, thermal and compositional conditions required to promote pegmatite growth there are three main theories behind pegmatite formation;

### •Metamorphic

Pegmatite fluids are created by devolatilisation (dehydration) of metamorphic rocks, particularly felsic gneiss, to liberate the right constituents and water, at the right temperature,

### •Magmatic

Pegmatites tend to occur in the aureoles of granites in most cases, and are usually granitic in character, often closely matching the compositions of nearby granites. Pegmatites thus represent exsolved granitic material which crystallizes in the country rocks,

### •Metasomatic

Pegmatite, in a few cases, could be explained by the action of hot alteration fluids upon a rock mass, with bulk chemical and textural change.

Metasomatism is currently not well favored as a mechanism for pegmatite formation and it is likely that metamorphism and magmatism are both contributors toward the conditions necessary for pegmatite genesis.

The mineralogy of a pegmatite is in all cases dominated by some form of feldspar, often with mica and usually with quartz, being altogether "granitic" in character. Beyond that, pegmatite may include most minerals associated with granite and granite-associated hydrothermal systems, granite-associated mineralization styles, for example greisens, and somewhat with skarn associated mineralization.

It is however impossible to quantify the mineralogy of pegmatite in simple terms because of their varied mineralogy and difficulty in estimating the modal abundance of mineral species which are of only a trace amount. This is because of the difficulty in counting and sampling mineral grains in a rock which may have crystals from centimeters to meters across.

Garnet, commonly almandine or spessartine, is a common mineral within pegmatites intruding mafic and carbonate-bearing sequences. Pegmatites associated with granitic domes within the Archaean Yilgarn Craton intruding ultramafic and mafic rocks contain red, orange and brown almandine garnet.

Tantalum and niobium minerals (columbite, tantalite, and niobite) are found in association with spodumene, lepidolite, tourmaline, cassiterite in the massive Greenbushes Pegmatite in the Yilgarn Craton of Western Australia, considered a typical metamorphic pegmatite unassociated with granite.

### Geochemistry

Pegmatite is difficult to sample representatively due to the large size of the constituent mineral crystals. Often, bulk samples of some 50–60 kg of rock must be crushed to obtain a meaningful and repeatable result. Hence, pegmatite is often characterized by sampling the individual minerals which comprise the pegmatite, and comparisons are made according to mineral chemistry.

Geochemically, pegmatites typically have major element compositions approximating "granite", however, when found in association with granitic plutons it is likely that a pegmatite dike will have a different trace element composition with greater enrichment in large-ion lithophile (incompatible) elements, boron, beryllium, aluminum, potassium and lithium, uranium, thorium, cesium, et cetera.

Occasionally, enrichment in the unusual trace elements will result in crystallization of equally unusual and rare minerals such as beryl, tourmaline, columbite, tantalite, zinnwaldite and so forth. In most cases, there is no particular genetic significance to the presence of rare mineralogy within a pegmatite, however it is possible to see some causative and genetic links between, say, tourmaline-bearing granite dikes and tourmaline-bearing pegmatites within the area of influence of a composite granite intrusion.

### Economic importance

Pegmatites are important because they often contain rare earth minerals and gemstones, such as aquamarine, tourmaline, topaz, fluorite, apatite and corundum, often along with tin and tungsten minerals, among others.

Pegmatites are the primary source of lithium either as spodumene, lithiophyllite or usually from lepidolite. The primary source for cesium is pollucite, a mineral from a zoned pegmatite. The majority of the world's beryllium is sourced from non-gem quality beryl within pegmatite. Tantalum, niobium, rare-earth elements are sourced from a few pegmatites worldwide, notably the Greenbushes Pegmatite. Bismuth, molybdenum and tin have been won

## Ore-Cutts

from pegmatite, but this is not yet an important source of these metals.

### Nomenclature

Pegmatites can be classified according to the elements or mineral of interest, for instance "lithian pegmatite" to describe a Li-bearing or Li-mineral bearing pegmatite, or "boron pegmatite" for those containing tourmaline.

There is often no meaningful way to distinguish pegmatites according to chemistry due to the difficulty of obtaining a representative sample, but often groups of pegmatites can be distinguished on contact textures, orientation, accessory minerals and timing. These may be named formally or informally as a class of intrusive rock or within a larger igneous association.

While difficult to be certain of derivation of pegmatite in the strictest sense, often pegmatites are referred to as "metamorphic", "granitic" or "Metasomatic", based on the interpretations of the investigating geologist.

### Occurrence

Worldwide, notable pegmatite occurrences are within the major cratons, and within greenschist-facies metamorphic belts. However, pegmatite localities are only well recorded when economic mineralization is found.

Within the metamorphic belts, pegmatite tends to concentrate around granitic bodies within zones of low mean strain and within zones of extension, for example within the strain shadow of a large rigid granite body. Similarly, pegmatite is often found within the contact zone of granite, transitional with some greisens, as a late-stage magmatic-hydrothermal effect of syn-metamorphic granitic magmatism. Some skarns associated with granites also tend to host pegmatites.

Aplite and porphyry dikes and veins may intrude pegmatites and wall rocks adjacent to intrusions, creating a confused sequence of felsic intrusive apophyses (thin branches or offshoots of igneous bodies) within the aureole of some granite.

### Scholarship Winner

Here is a letter from our most recent SB City College Scholarship winner:

May 13, 2012

Dear Mr. Mills and Orcutt Mineral Society Members:

I would like to express my sincerest gratitude to you for awarding me the \$150 scholarship to be used towards the expense of the Colorado Plateau Field Study course at Santa Barbara City College. Without your support, this course, which I am extremely interested in, simply would not have been an option for me. As you may know, class registration fees for the coming fall semester strakes at roughly the same time as final payments are due for the field seminar.

This can leave many participating students, myself included, financially devastated. I am thankful for the support you are offering, and am looking forward to the knowledge and experiences I will gain in the coming weeks, all made possible due to your generous contribution to my education. Thank you so very, very, much!

Sincerely,

Kevin Bibby

Things are Picking-up on 166

Wayne Mills, Adopt A Highway Coordinator

Well, we did it again, thanks to the "Faithful Few" who showed up at 0800 on a sunny Saturday morning. Wes, Jeannie and Marty Lingerfelt, Don and Sylvia Nasholm, Mike and Samantha Schmidt, Geary Sheffer, Truman Burgess and Wayne Mills met at the southeast corner of Route 101 and 166 east for the bi-monthly highway clean-up that was part of Caltrans "Great American Clean-up" month. The clean-up went pretty quickly, as there was relatively little trash, and correspondingly fewer cans and bottles. We got about 7 bags of trash and two bags of cans and plastic bottles as wells as a broken cell phone, socket tool, and an "adult" magazine. We were outta' there by about 0930.

The clean-up was followed by pie, sweet rolls, biscuits and gravy and coffee at Francisco's in Santa Maria. We had a nice "chat" about various rock-related (and other) topics.

All who showed-up are thanked for their participation in this, one of our more arduous (but not too) public benefit activities.

## Rocking the Central Coast

Wayne Mills, Education Chair

Shortly after completing the highway clean-up on Saturday May 11 (and after gobbling down a piece of hot apple pie and coffee), I picked up OMS legend Ralph Bishop, and some of his wonderful specimens, and we drove over to the Santa Maria Public Library where I was slated to give a talk to the Santa Maria Valley Historical Society via their "Valley Speaks" program. The program was arranged by Shirley Contreras, a former member of OMS, and long-time coordinator of the "Valley Speaks" program. My talk was entitled "History of the Orcutt Mineral Society, and Rocks, Fossils and Minerals of the Central Coast".

About 30 folks were in attendance, and they seemed interested in the 50 slides that I showed. After the presentation (which was videotaped), I fielded several

questions about local materials, and was shown several rocks—most of which Ralph and I could identify, and two that we were unsure of. As you can see from the poster that was shown at the entrance to the talk, and infer from the professionalism of the videographer, Valley Speaks treats their speakers quite well. It was a pleasurable experience.

## **A Brief History of the Orcutt Mineral Society**

By Wayne Mills

The Orcutt Mineral Society (OMS) was founded in 1958. The Santa Maria Gem and Mineral Society (SMGMS) were operating at the same time. For a while, the two societies coexisted, with over 100 members in each group. When SGMS dissolved in the 1960's, several of its members joined OMS. OMS has grown from 21 charter members in 1958, to an organization of some 60 members currently. For many years we met in the Elwin Mussell Center, and we have had two other "homes" in the last 4 years. We currently meet on the 2nd Tuesday of the month (at 7:00 p.m.) at the Oasis Senior Center on Soares Avenue in Orcutt, CA.

It is appropriate that we now meet in Orcutt, because we are named after William Orcutt, a petroleum geologist for Union Oil Company who, in the late 1800's explored for oil in the hills just south of the town that is now named for him. In 1906, Orcutt discovered what is now the LA Brea Tar Pits, one of the richest troves of Pleistocene-aged fossils in the world, on the property of Captain Allan Hancock—a name many Santa Marians may be familiar with.

OMS has many public benefit activities, including:

1. Education Program—Earth Science related talks to local schools, pebble pup training.
2. Adopt-A-Highway program—bi monthly clean-up the first 2 miles of Highway 166 east of Highway 101.
3. Scholarship Program—for the past 15 years (at least) we have awarded scholarships to one or both of our local Junior Colleges (Cuesta College and Alan Hancock College). This year, we gave the scholarship to Santa Barbara City College because no eligible candidates were found at the other institutions.
4. Abused Children Program—for the past several years at Christmas time, we have given donations of gift certificates to Santa Barbara Social Services Division for their abused and neglected children.
5. Canned Food Drive—at our annual meeting, we collect cans of food to give to the Salvation Army at Christmastime.
6. Campbell's Soup Labels—for many years we have supported Sun Valley Indian School in Arizona by collecting Campbell's Soup Labels. With ours and other

label donations, the school had been able to buy several busses for transporting their youth.

7. Pull tabs—we also save pull tabs from soft and hard drinks for Ronald McDonald House. About 1400 pull tabs equals \$1.00 towards helping families of individuals being treated at the Ronald McDonald Hospital get accommodations at nearby motels. Some of our members drink a LOT of Coke and Pepsi, and others...

In a way, our annual show is a public benefit activity as well, because it gives our visitors the opportunity to see a variety of exquisite jewelry, minerals, fossils and other lapidary work that is not ordinarily seen in this area. In addition, our red-vested members can often answer questions about rocks, fossils and minerals found in the area. And, profits from the show help fund the annual scholarships that OMS gives to local Junior Colleges. This year we are holding our 45th annual show—not bad for a 56 year-old club.

Our First Show was held in 1958, the year we were formed. We have held our show at various venues. For many years it was held at the Fairgrounds in Santa Maria, and then it "moved" to the Arroyo Grande High School Parking Lot for our outdoor show, and to the Five Cities Community Center near the Arroyo Grande Public Library for our indoor show. After a while, two shows a year got to be too much for many members, so for the last 10 years, we have held a combined (indoor/outdoor) show at St. Joseph's Church in Nipomo. That was a wonderful venue for us. This year, we are trying a new venue, Nipomo High School, also located on Thompson Avenue in Nipomo. This will be our 45th Annual show, and it will be held on the weekend of August 3-5. This is our main fund raiser for the year's activities (even though admission is free!) I am confident that it will be a wonderful show with the hard work and creativity of the eager members of our club. The show features displays of lapidary materials, about 60 dealers in all things related to rocks, fossils and minerals, demonstrations of lapidary arts, a food booth, and a highly anticipated Santa Maria Style barbecue Saturday evening.

We have had 41 presidents in the last 54 years, and our current president, Debbie Hood has held that position more often than anyone. She has been at the helm of the society times—each time a 3-year commitment. Some might argue that that is enough to qualify one for commitment to a different kind of institution...

## **And the Head Stone's connected to the Neck stone and by Wayne Mills**

All this time, I thought the Easter Island Heads were just that—big heads. NOW I find out that scientists have been digging them up over the last six

years or so, and have found that the big guys (heads alone are 10-12 feet long), actually have attached bodies. Wow!

For hundreds of years since their discovery, folks were wondering how they got all those heads in position because of their tremendous weight. The Easter Islanders supposedly rolled them into place from the quarries some three or more miles away on the trees (that no longer exist on the island) between 1250 and 1500 AD. Now, science has twice as much weight to ponder how it got into place, and then how/why they covered half the statue up! Read more about the excavations at the site for the Easter Island Statue Project (<http://www.eisp.org/>).

The movie "Rapa Nui" is a pretty good film depicting the life of the islanders during the time the heads were being made.

## **ORCUTT MINERAL SOCIETY BOARD MEETING, HOME OF JANIS & STAN FERGUSON, ARROYO GRANDE, CA. MAY 1, 2012**

President Debbie Hood called the meeting to order at 7:00 pm.

Members present were: Jeannie Lingerfelt, Sandy Berthelot, Janis Ferguson, Jeanne Brown, & Michael Schmidt. Guests included Paul Berthelot & Bill Hood. Wayne Mills arrived after meeting was adjourned and was updated, (thus, no quorum.).

### **MINUTES:**

Debbie Hood read the minutes of the April 10, 2012 general meeting. The minutes were approved as presented.

### **TREASURER'S REPORT**

Debbie Hood gave the treasurer's report in Wes Lingerfelt's absence, for period ending April 30, 2012. Janis Ferguson pointed out an error regarding acquisition of Seatrain storage unit. The treasurer's report was accepted as corrected.

### **CORRESPONDENCE:**

None, it was noted that Wes Lingerfelt picked up the mail, but was ill thus was not present. Wes Lingerfelt is to hand over show notices, etc. to Debbie Hood for bulletin.

### **COMMITTEE REPORTS:**

1. Bulletin-still work in progress (cleanup of corruption).
2. Refreshments- Pies are next meeting
3. Abused Children's' Fund-donations are down and we are behind enough we may need to revise the club's outgoing commitments.

4. CFMS-next meeting is in July, be sure to speak to Wes if you have anything to present/request.
5. Sunshine- Life member Molly Kerlick has passed away.
6. Membership-Membership Red Books are finished and being distributed, see Wes L.
7. Field Trip-still needs a chairperson.
8. Adopt-a-Highway – next meeting to be Sat May 12, 2012; meet at junction of highways 101/166.
9. Breakfast is on 5/26 (in bulletin).

### **OLD BUSINESS:**

1. It was noted in April minutes, due to lack of a quorum, that the motion to increase donation to Oasis Senior Center from \$300 to \$500 for use of facilities. In that there is no quorum present tonight either...this shall be tabled till the May general meeting for vote.

2. Library-new chairpersons are Mike Schmidt & Samantha S. The book inventory is now on the club web site. Check it out!

### **NEW BUSINESS:**

Jeanne Brown presented to board her interest in the signage for the show. Debbie Hood presented to board to start a new committee; signage for show, & Debbie Hood volunteered Jeanne Brown to be chairperson. In that no quorum was present; this will also be tabled until the May general meeting for vote. And it was discussed that Renee is re-painting the old signs and that Wes & Wayne have data for media.

The General meeting is to be Tuesday evening, 5/07/12, 7:00 pm. The program will be a presentation by Wes Lingerfelt on the "CA Blue Mine" in Yucca Valley, CA; and world class gems and minerals being discovered at that site. Display to be Silver Jewelry club members have made.

Minutes respectfully submitted,

Jeanne L. Brown, Secretary

Santa Maria Terrace retirement home dining room @ 1405 E. Main St, Santa Maria, CA is reserved for the 12/08/2012 annual meeting

### **A CALL TO ALL MEMBERS:**

OMS needs your rock related donations for door prizes...please contact any board member

**ORCUTT MINERAL SOCIETY GENERAL MEETING** Luis Oasis Senior Ctr., 420 Soares Ave, Orcutt, CA. MAY 8, 2012

President Debbie Hood called the meeting to order at 7:00 pm.

Invocation was given by Roger Lehman.

Flag saluted by Samantha S.

Hospitality: We had 30 members and 3 guests in attendance.

## Ore-Cutts

**MINUTES:** Jeanne Brown read the minutes of the May 1, 2012 board meeting. The minutes were approved as corrected. (Note that Molly Kerlick (not Colleck) has passed away).

**TREASURER'S REPORT:** Wes Lingerfelt gave the treasurer's report for period ending 4/30/12. The treasurer's report was accepted as presented.

**CORRESPONDENCE:** Jeanne Brown reported on several newsletters and ads for other chapter gem shows and fairs. All are on the hospitality table for review.

### COMMITTEE REPORTS.

1. Gem Show: Wes Lingerfelt reviewed the budget of \$8,000 for show costs-discussed and accepted as presented. Margaret Henson will be in charge of the kitchen. Flyers are being worked on. Jeanne Brown is mapping out new sign sites. Renae Sutcliffe is re-painting the old signs. Jeanne Brown requested a budget for new signs. Discussion followed. (Was a budget given her?)
2. Bulletin-still a work in progress-cleanup of corruption.
3. Budget & Audit: no report at this time.
4. Refreshments- Pies tonight were brought by Jan Ferguson, Jeanne Lingerfelt, Sandy Berthelot & Lucky Virgin.
5. Abused Children's Fund-no report.
6. Historian-no report.
7. CFMS-no report.
8. Sunshine-Jeanne Lingerfelt out sick with the flu; Margaret & Mike Henson have bronchitis; Geary Schaffer's brother passed away & Molly Kerlick passed away.
9. Membership-no report.
10. Education-Wayne read thank you letters from the 5th grade class of Oceanview for his recent talk about rocks & minerals.
11. Scholarship-Wayne received a thank you letter from Santa Barbara City College.
12. Field Trip-no report
13. Adopt-a-Highway: next scheduled date is second Saturday in May; 5/12/12. We meet at 8:00 am on the Southeast corner of Hwy 166 @ the Hwy 101 northbound off ramp.
14. Library: -new librarians are Mike Schmidt & Samantha. The club library inventory is now on our website.

15. Breakfast-to be at Sunset Ridge Golf Course in Santa Maria on Sat, 5/26/12 at the Sunrise Café.

16. Old Business: -no report.

17. New Business: -the upcoming club BGQ & Potluck is scheduled to be 6/09/12 @ Pioneer Park in Santa Maria on Foster Road.

Club has obtained a Seatrain, 40' long, for storage- Jeanne & Bill Brown donated brick for entry base. It was requested by Wes Lingerfelt that a budget be established for maintenance of storage locker. Discussion followed & it was moved and seconded to have a budget of \$500.

The Program this evening, narrated by Wes Lingerfelt, is a slide show of David Schmidt's "CA BLUE MINE"; and some of his world class gems.

Meeting was adjourned at 8:50 pm.

Minutes respectfully submitted,

Jeanne L. Brown, secretary

May 11, 2012

**ANNUAL MEETING:** Santa Maria Terrace retirement home dining room @ 1405 E. Main St, Santa Maria, CA is reserved for the 12/08/2012 annual meeting.

**NOTE TO ALL MEMBERS:** OMS needs your rock related donations for door prizes...please contact any board member.

## Shop Helps

By Brad Smith

### *Loose hammer heads –*

*Flying off the handle is never good, particularly if it's a hammer head. The traditional way to tighten a loose hammer head is to tighten it by soaking the head end with the hammer head still attached in hot water, then driving in a small metal wedge. I have also tried super glue and found that the glue doesn't hold up to repeat hammering.*

### *Source for small plastic parts –*

*We often need a piece of plastic in our studio, such as for a bracket, a single part die, or for a template. So it's handy to have a small supply along with the rest of your sheet, wire, copper and bronze. But we seldom think to buy and stock any plastic.*

*When I was over to our local plastics store one time, it was a surprise to find out they have a scrap bin out back where they give away small pieces and scraps. I usually just go for the 3/8 and 1/2 inch thicknesses for use as forming dies, but there's always a variety of sizes and colors to choose from including thin sheets that are good for templates.*

*So next time you go to your local plastics business, it's worth asking to see if they have a scrap bin.*

### **CLEANING SOLDER OUT OF A BEZEL -**

*Sometimes when you solder a bezel to a base plate you end up with excess solder that needs to be removed before*

## Ore-Cutts

setting the stone. My choice of tool for this is called an "Inverted Cone" bur used in a rotary tool or flexshaft. It cuts on both the bottom and the side and is shaped so that there's less chance of cutting into the bezel wall than if you used the more common cylinder bur shape. I find the 2 or 3 mm size useful for almost any bezel. For a pic of this bur see [riogrande.com/Search/cone-bur](http://riogrande.com/Search/cone-bur)

More BenchTips by Brad Smith are at  
[groups.yahoo.com/group/BenchTips/](http://groups.yahoo.com/group/BenchTips/)  
 or [Facebook.com/BenchTips](http://Facebook.com/BenchTips)

### June 2012 Calendar

Tuesday June 5, 2012 7:00 to 8:30 pm	OMS Board Meeting- The Henson's home. All members are welcome at this business meeting. For information or directions, call Mike Henson at (805) 934-1308.
Saturday June 9, 2012 11:00 am to 3:00pm	Semi-Annual Meeting & BBQ at Pioneer Park bring a dish to share and rocks for the silent auction.
	Field Trip to be announced if someone takes the Fieldtrip Chairmanship.
Saturday June 23, 2012 9:00 to 10:00 am	OMS Monthly Breakfast-Home Town Buffet, 1431 S. Bradley Road, Santa Maria.

### July 2012 Calendar

Tuesday July 3, 2012 7:00 to 8:30 pm	OMS Board Meeting-At the Henson home. All members are welcome at this business meeting. For information or directions, call Mike Henson at (805) 934-1308.
Tuesday July 10, 2012 7:00 to 9:00 pm	OMS General Meeting- Luis Oasis Senior Center. <ul style="list-style-type: none"> <li>• Program-"</li> <li>• Display-1'x1' display-anything goes.</li> <li>• Refreshments-</li> </ul>

Saturday July 14, 2012 8:00 to 10:00 am	Roadside Clean up After the cleanup, coffee and pastry at "Francisco's Country Kitchen" in Santa Maria.
Saturday July 21, 2012 8:00 am to 5:00 pm	Field Trip to be announced if someone takes the Fieldtrip Chairmanship
Saturday July 28, 2012 8:15 to 9:15 am	OMS Monthly Breakfast- The Girls Restaurant, 1237 Grand Ave., Arroyo Grande.

### Show Schedule 2012

#### JUNE 2012

#### June 9 - 10: LA HABRA, CA

North Orange County Gem & Mineral Society  
 La Habra Community Center  
 101 W. La Habra Blvd.  
 Hours: 10 - 5 daily  
 Contact: Loretta Ogden, (909) 598-2456, (909) 217-5864 Cell  
 Email: [fbriktr1@aol.com](mailto:fbriktr1@aol.com)  
 Website: [www.nocgms.com](http://www.nocgms.com)

#### June 16 - 17 Cayucos, CA,

**51st Annual Cayucos Gem & Mineral Show  
 Veteran's Memorial Building  
 Highway 1 at the Pier Cayucos, CA  
 More Information: <http://www.slogem.org/4->**

#### June 16 - 17: GLENDORA, CA

Glendora Gems & Mineral Society  
 Goddard Middle School  
 859 East Sierra Madre  
 Hours: Sat. 10 - 5; Sun. 10 - 4  
 Contact: Bonnie Bidwell, (626) 963-4638  
 Email: [Ybidwell2@aol.com](mailto:Ybidwell2@aol.com)

#### June 30 - July 1: CULVER CITY, CA

Culver City Rock & Mineral Club  
 Culver City Veteran's Memorial Auditorium  
 4117 Overland Avenue (Overland & Culver)  
 Hours: Sat 10 - 6; Sun 10 - 5  
 Contact: Robert Thirlaway, (310) 462-2269  
 Email: [fiestaofgems@gmail.com](mailto:fiestaofgems@gmail.com)

Website: [www.culvercityrocks.org](http://www.culvercityrocks.org)

### JULY 2012

#### July 13 - 15: RIVERSIDE, CA



## Ore-Cutts

### **CFMS GOLD AND GEM SHOW & CONVENTION**

Hosted by Valley Prospectors  
Riverside Municipal Auditorium  
3485 Mission Inn Avenue  
Hours: Fri & Sat 10 – 5; Sun 10 – 4  
Contact: Steve Schubert, Show Chair, (951) 943-0535  
Email: meschubert@hotmail.com

### **AUGUST 2012**

#### **August 3 - 5: NIPOMO, CA**

Orcutt Mineral Society  
Nipomo High School  
525 North Thompson Ave.  
Hours: 10 - 5 daily  
Contact: Wes Lingerfelt, (805) 929-3788  
Website: [www.omsinc.org](http://www.omsinc.org)

#### **August 4 - 5: SAN FRANCISCO, CA**

San Francisco Gem & Mineral Society  
Building 1, Treasure Island  
1 Avenue of the Palms  
Hours: Sat 10 - 6; Sun 10 - 5  
Contact: Ellen Nott  
Email: [ellen\\_nott@yahoo.com](mailto:ellen_nott@yahoo.com)

#### **August 31 - September 3: FORT BRAGG, CA**

Mendocino Coast Gem & Mineral Society  
Town Hall  
Corner of Main & Laurel Street  
Hours: Fri-Sun 10 - 6; Mon 10 - 4  
Jerry Sommer, (707) 937-1833  
Hours: 10 - 5 daily  
Contact: Dorothy Tonnacliff (209) 603-4539 or  
Jan Bradley (209) 629-3878  
Email: [slmshow@juno.com](mailto:slmshow@juno.com)  
Website: [www.stocktonlapidary.com](http://www.stocktonlapidary.com)

### **SEPTEMBER 2012**

#### **September 8 - 9: DOWNEY, CA**

Delvers Gem & Mineral Society  
Woman's Club of Downey  
9813 Paramount Blvd.  
Hours: 10 - 5 daily  
Contact: Jon Fults, (714) 856-7548, (714) 287-5743 cell  
Email: [jhfults@verizon.net](mailto:jhfults@verizon.net)

#### **September 15 - 16: BORON, CA**

Mojave Mineralogical Society  
Boron Community Park & Building  
27177 – 20 Mule Team Road  
Hours: 8 – 4 daily

Contacts: Steve Breckenridge (760) 559-0872,  
[Rock5b@starband.net](mailto:Rock5b@starband.net)  
David Eyre, (760) 762-6861,  
[david\\_eyre@mail.com](mailto:david_eyre@mail.com)



### **Big Price Reduction!**

White's Spectrum XLT Metal Detector

Second search coil, and accessories. \$300.00

Call Bill Hood at (805) 481-6860 for more information

**OMS Webmaster - Wes Lingerfelt – (805) 929-3788.**

Check out our OMS web site at <http://www.omsinc.org> or send e-mail to [info@omsinc.org](mailto:info@omsinc.org).

Copyright 2008 Orcutt Mineral Society. Material in this newsletter may be duplicated provided that credit is given this publication and the author(s). For commercial use, the individual author(s) must be contacted. Editor may be contacted c/o OMS, P.O. Box 106, Santa Maria, Ca. 93456-0106, or via club web site.

OMS Webmaster - Wes Lingerfelt – (805) 929-3788.  
Check out our OMS web site at <http://www.omsinc.org> or send e-mail to [info@omsinc.org](mailto:info@omsinc.org).

OMS Membership \$24.00 for Individual, \$34.00 per couple, \$5.00 Each Additional Family Member, \$5.00 Juniors under age of 18, \$10.00 one-time initiation fee for new members.  
Membership Chairperson is Jeanne Brown (805) 481-1811

### **2012-OMS Officers**

Pres.	Debbie Hood	(805) 481-6860
Pres. Elect	Wayne Mills	(805)481-3495
Secretary	Jeanne Brown	(805) 481-1811
Treasurer	Wes Lingerfelt	(805) 929-3788
Immed. PastPres.	Gloria Dana	(805) 929-6429
Federation. Rep.	Wes Lingerfelt	(805) 929-3788

### **2012- OMS Board Members**

Jeannie Lingerfelt	(805) 929-3788
Jan Ferguson	(805) 474-9977
Sandy Berthelot	(805) 349-3977
Mike Schmidt	(805) 260-3741
Mike Henson	(805) 934-1308

## Ore-Cutts



ORE-CUTTS (named after, William Orcutt) was published in 1966. Member Helen Azevedo was the first editor. Orcutt Mineral Society was founded in 1958, and was named after William Orcutt, a geologist and Civil engineer who worked in the Santa Maria Valley as a District manager for Union oil Company in 1888. In 1889, William Orcutt discovered the mineral and fossil wealth of the La Brea Tar Pits on the property of Captain Alan Hancock. The La Brea Tar Pits are one of the most significant fossil finds in paleontological history. The OMS is a non-profit club dedicated to stimulating an interest in the earth sciences. The club offers educational programs, field trips, offers educational programs, field trips, scholarships, and other opportunities for families and individuals to pursue an interest in the collecting and treatment of lapidary materials, fossils, gems, minerals, and other facets of the Earth Sciences. In addition, another goal of this Society is to promote good fellowship, and proper ethics in pursuit of the Society's endeavors. Operating Rules have been set forth to guide the Officers and members of the Society in accomplishing these aims. Affiliations of the OMS include American Federation of Mineral Societies, and California Federation of Mineral Societies

### OMS Editor

Debbie Hood	(805) 481-6860	<a href="mailto:debihood1@sbcglobal.net">debihood1@sbcglobal.net</a>
-------------	----------------	--

Orcutt Mineral Society, Inc.  
PO Box 106  
Santa Maria, CA. 93456-0106

*ADDRESS CORRECTION REQUESTED*

